

#### ITEMS LIST

**OPTION 1 - 2111.31777**

**Equipment**

1. Bridge	Ref: J2613A
2. 2x ILP 300mm High Single Stand Alone Mushroom Seat	Ref: UKILPMS300
3. Little Steps	Ref: J12A
4. Rocking Path	Ref: J14A
5. Fahr Tic Tac Toe Play Panel (800x595mm) including 2No. posts	Ref: UKFITICTAC6

**Ancillaries**

6. Existing Bin	
7. Existing Fence	

**Safety Surfacing**  
Area to be surfaced with 3m<sup>2</sup> Grassmat as shown.

**Miscellaneous**  
Prelims have been included.

**Optional Extras**  
Post Installation Inspection.

**OPTION 2 - 2111.31779**

**Equipment**

8. Spinning Bowl	Ref: J2411A
9. Star Springler	Ref: J856A
10. Fahr Tic Tac Toe Play Panel (800x595mm) including 2No. posts	Ref: UKFITICTAC6

**Ancillaries**

11. Existing Bin	
12. Existing Fence	

**Safety Surfacing**  
Area to be surfaced with 21m<sup>2</sup> Grassmat as shown.

**Miscellaneous**  
Prelims have been included.

**Optional Extras**  
Post Installation Inspection.

**OPTION 3 - 2111.31781**

**Equipment**

13. Chickies Springer	Ref: J846A
14. Climbing Hut	Ref: J254A

**Ancillaries**

15. Existing Bin	
16. Existing Fence	

**Safety Surfacing**  
Area to be surfaced with 18m<sup>2</sup> Grassmat as shown.

**Miscellaneous**  
Prelims have been included.

**Optional Extras**  
Post Installation Inspection.

**OPTION 4 - 2111.31782**

**Equipment**

17. Double Perch	Ref: J986A
18. Fahr 3 in a Row Game Play Panel (800x595mm) including 2No. posts	Ref: UKFIROW6

**Ancillaries**

19. Existing Bin	
20. Existing Fence	

**Safety Surfacing**  
Area to be surfaced with 15m<sup>2</sup> Grassmat as shown.

**Miscellaneous**  
Prelims have been included.

**Optional Extras**  
Post Installation Inspection.

*Proposed Grassmat Safer surfacing is based on a fully established grass site (including a minimum of 150mm of good quality soil and turf).*

*Proposed Grassmat will follow the natural contours of the land.*

*Preliminaries have been included within your quotation, these equate to site setup, site storage, unloading of equipment, site welfare, heras fencing & signage and skips (this can also include supervision where necessary).*

*Some images shown are for illustrative purposes only. The quote and items list will show the exact equipment used.*

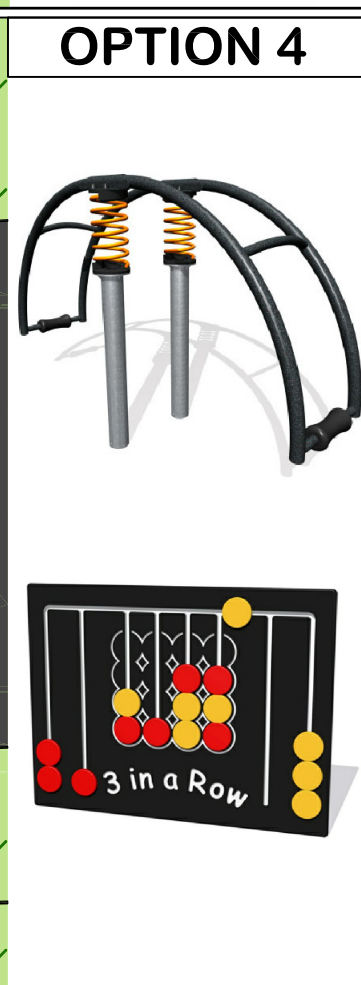
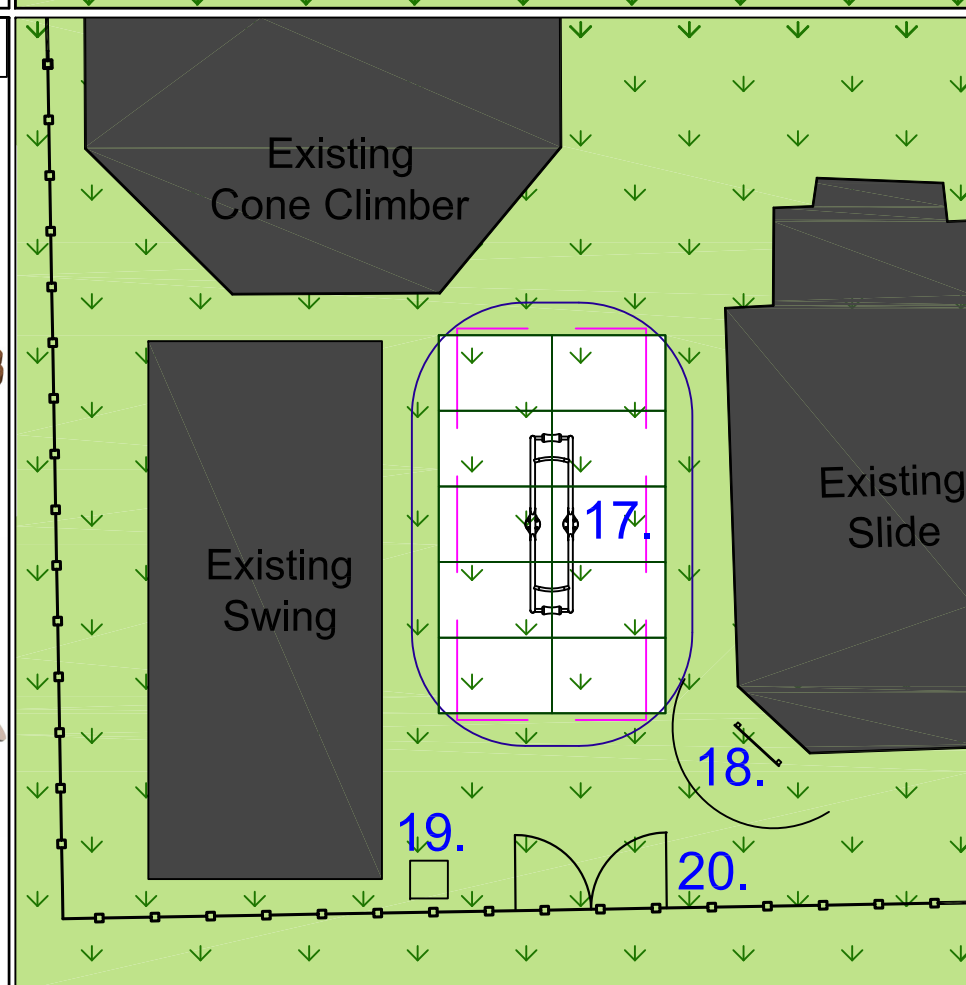
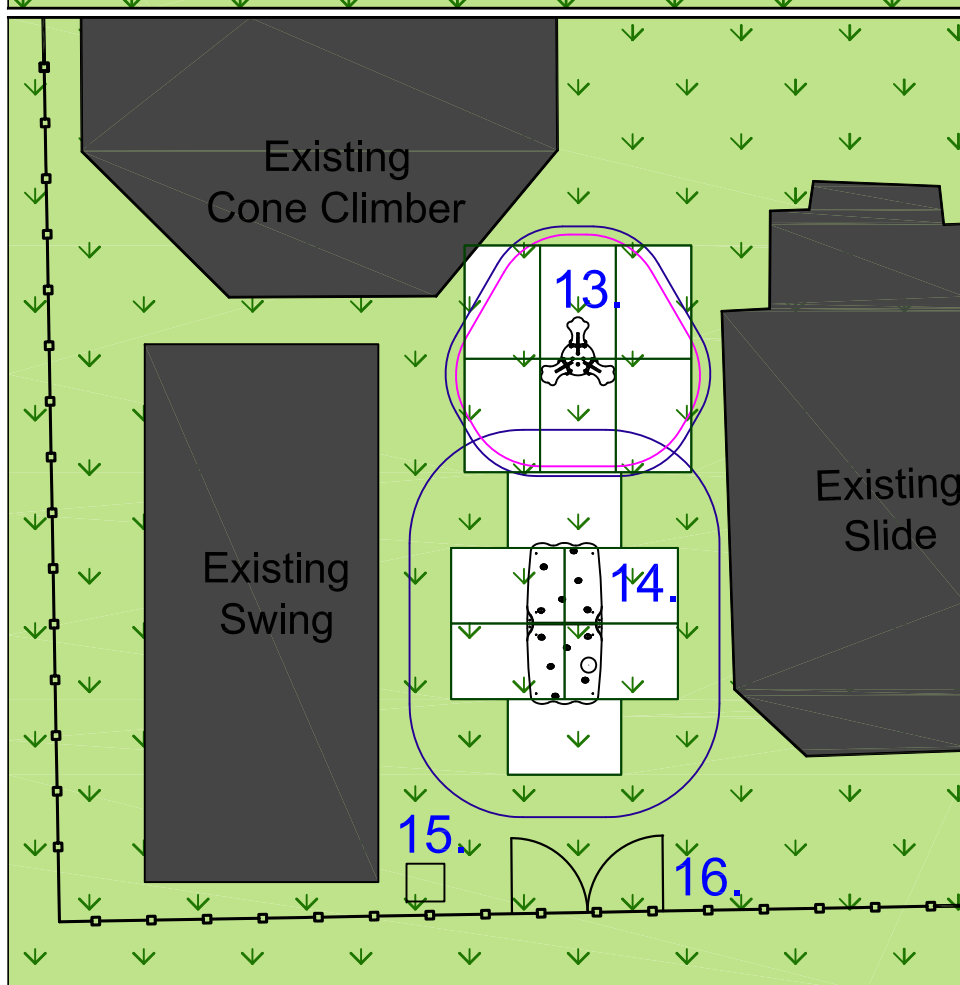

**PRODUCT KEY**

	Grassmat		Existing Wetpour
	Existing Grass		Existing Fence/line
	Free Fall		Free Space

# Quarry Road Play Area

Witney Town Council

DATE: 16/11/2021 REF: 2111.31777(QuarryRd\_WitneyTC)

REV: - DB: RMS CB: PP

SCALE: 1:100 @ A3

