

66B HIGH ST **66A HIGH ST**
FIRST FLOOR PLAN

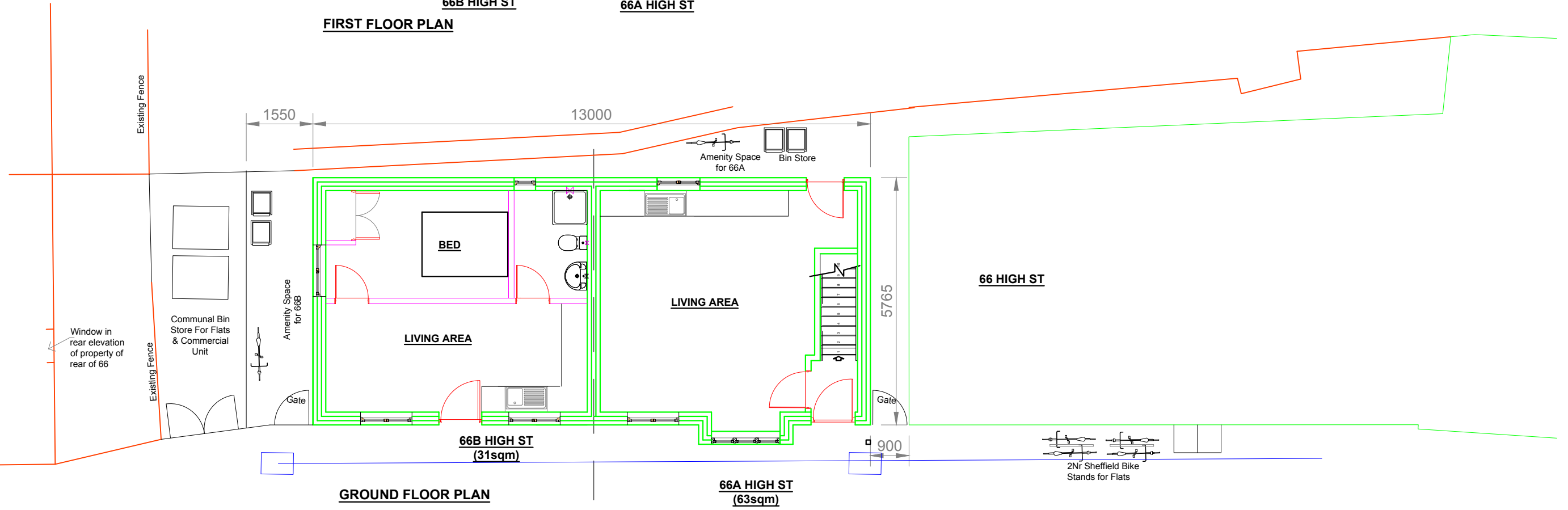

66B HIGH ST (31sqm) **66A HIGH ST (63sqm)**
GROUND FLOOR PLAN

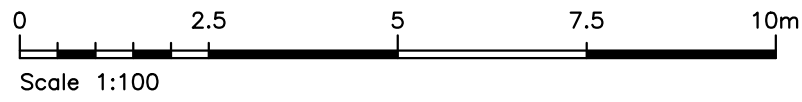

A	66B was two storey	20.8.20
REVISIONS		

Robin Akers Ltd
 Architectural Consultants
 1 Lee Close, Charlbury,
 Oxon OX7 3SG
 tel 01608 810012
 e-mail robin@robinakersltd.co.uk

JOB:
 1 x 2-BED COTTAGE, 1 x 1-BED
 FLAT & BIN STORE @
 66 HIGH STREET
 WITNEY

DRAWING: Proposed Floor Plans		
DRAWN:	CHECKED:	
SCALES: 1:100@A3	DATE: 5.5.20	
JOB No.	DRAWING No. P3	REV. A