

GROUND FLOOR PLAN LAYOUT

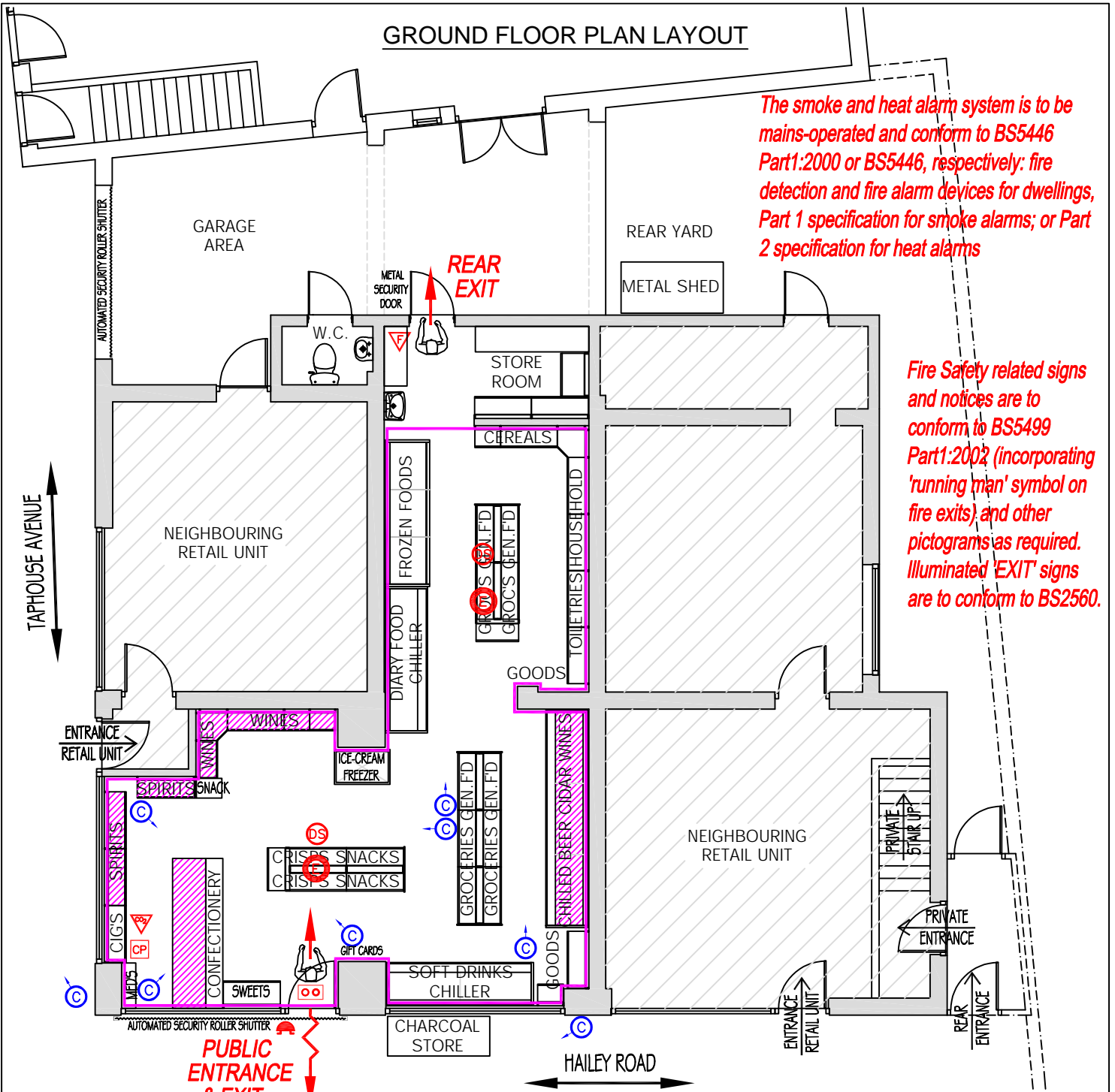

The smoke and heat alarm system is to be mains-operated and conform to BS5446 Part1:2000 or BS5446, respectively: fire detection and fire alarm devices for dwellings, Part 1 specification for smoke alarms; or Part 2 specification for heat alarms

Fire Safety related signs and notices are to conform to BS5499 Part1:2002 (incorporating 'running man' symbol on fire exits) and other pictograms as required. Illuminated 'EXIT' signs are to conform to BS2560.

An electrically operated fire alarm system should comply with BS5839 Part1: 2017. The electrical installation should comply with Approved Doc. P (electrical safety). It is essential that the fire detection and fire alarm systems are properly designed, installed and maintained. Where a fire alarm system is installed, an installation and commissioning certificate should be provided.

The emergency lighting installation is to comply with BS5266 Part 1:2016 and the attention of the design/installing engineer drawn to paragraph 3.1 (construction and records) of BS5266 Part1:2016, which requires consultation with the Fire Authority. Firefighting equipment is to conform with BS EN3.

FIRE REGULATION SYMBOLS

- Exit Boxes
- Escape Lighting Points
- Fire Extinguisher Foam
- Fire Extinguisher CO²
- Auto Smoke detector
- Audible Warning Device
- Control Panel
- CCTV Camera
- Extent of licenced area

LICENSED Trade Legal Services Ltd

LTLs LTD, REGENT HOUSE, BATH AVENUE, WOLVERHAMPTON, WEST MIDLANDS, WV1 4EG
Tel: 01902 810048 Fax: 01902 810047 Mobile: 07793 315898 email: ltl@westmids@hotmail.com

Application	Location
APPLICATION FOR A VARIATION TO A PREMISES LICENCE	Premises to be known as: HAILEY EXPRESS 65B Hailey Road, Witney Oxfordshire OX28 1HJ
By J.S. Uppal	Date 09/08/2023
Drwg No.	HAILEYEXPRESS-01

5 Metres @ Scale 1:100

0 1 2 3 4 5